

**NOTICE!!**

**These documents have been scanned!**

**Do not place un-scanned documents beneath this notice!**

**Do not remove this notice from this file!**

GPO Jacket No. 560-102  
Print Order 61540  
Rise Business Services, LLC  
Job=AZ15 5/8/2019



Box Number= AZ15024



Claim Begin-End: AMC433776-AMC433776

1 Initial Receipt



AZ15024-27

AMC433502-AMC433786

**AMC#**

**DATE CLOSED**

**REMARKS**

433776

AMC#	DATE CLOSED	REMARKS
433776		

**United States Department of the Interior**  
**Bureau of Land Management**  
 LANDS/RECREATION & PLANNING  
 ONE N CENTRAL AVE  
 PHOENIX, AZ 85004 -2203  
 Phone: 602-417-9200

Receipt

No: 3397649

<b>Transaction #:</b> 3496176	
<b>Date of Transaction:</b> 09/23/2015	
CUSTOMER:	
JEFFREY BLUM 550 N ASPEN DR CHANDLER, AZ 85226-2718 US	

LINE #	QTY	DESCRIPTION	REMARKS	UNIT PRICE	TOTAL
1	1.00	LOCATABLE MINERALS / MINING CLAIMS-NEW, UNADJUD, ONE OR MORE AUTH NOS / NEW MINING CLAIMS LOCATION FEE <b>CASES:</b> AMC433776/\$37.00		- n/a -	37.00
2	1.00	LOCATABLE MINERALS / MINING CLAIMS-NEW, UNADJUD, ONE OR MORE AUTH NOS / NEW MINING CLAIM PROCESSING FEE <b>CASES:</b> AMC433776/\$20.00		- n/a -	20.00
3	1.00	LOCATABLE MINERALS / MINING CLAIMS-NEW, UNADJUD, ONE OR MORE AUTH NOS / NEW MINING CLAIMS MAINTENANCE FEE <b>CASES:</b> AMC433776/\$155.00		- n/a -	155.00
<b>TOTAL:</b>					<b>\$212.00</b>

PAYMENT INFORMATION			
1	AMOUNT:	212.00	POSTMARKED: N/A
	TYPE:	CASH	RECEIVED: 09/23/2015
	NAME:	BLUM, JEFFREY 550 N ASPEN DR CHANDLER AZ 85226-2718 US	

REMARKS

This receipt was generated by the automated BLM Collections and Billing System and is a paper representation of a portion of the official electronic record contained therein.

**NOTICE!!**

**These documents have been scanned!**

**Do not place un-scanned documents beneath this notice!**

**Do not remove this notice from this file!**

GPO Jacket No. 560-102  
Print Order 61540  
Rise Business Services, LLC  
Job=AZ15 5/8/2019



Box Number= AZ15024



Claim Begin-End: AMC433776-AMC433776

2 Correspondence



AZ15024-27

AMC433502-AMC433786

**SENDER: COMPLETE THIS SECTION**

- Complete items 1, 2, and 3.
- Print your name and address on the reverse so that we can return the card to you.
- Attach this card to the back of the mailpiece, or on the front if space permits.

1. Article Addressed to:

**JEFFREY BLUM**  
**52 S. BEVERLY, LOT D13**  
**MESA, AZ 85210-8478**  
**9200/RM/AMC433776**



9590 9402 1932 6123 9273 80

2. Article Number (Transfer from service label)

7017 0660 0000 3024 1065

**COMPLETE THIS SECTION ON DELIVERY**

A. Signature

X

 Agent Addressee

B. Received by (Printed Name)

" "

C. Date of Delivery

10/20/17

D. Is delivery address different from item 1?

 Yes

If YES, enter delivery address below:

 No

3. Service Type

- Adult Signature
- Adult Signature Restricted Delivery
- Certified Mail®
- Certified Mail Restricted Delivery
- Collect on Delivery
- Collect on Delivery Restricted Delivery
- Insured Mail
- Registered Mail™
- Registered Mail Restricted Delivery
- Return Receipt for Merchandise
- Signature Confirmation™
- Signature Confirmation Restricted Delivery
- Priority Mail Express®
- Registered Mail™
- Registered Mail Restricted Delivery
- Return Receipt for Merchandise
- Signature Confirmation™
- Signature Confirmation Restricted Delivery

 Registered Mail Restricted Delivery (500)

USPS TRACKING #



First-Class Mail  
Postage & Fees Paid  
USPS  
Permit No. G-10

9590 9402 1932 6123 9273 80

United States  
Postal Service

RECEIVED  
BLM AZ STATE OFFICE

• Sender, please print your name, address, and ZIP+4® in this box •

2017 OCT 23 P 2:10 P

U.S. DEPARTMENT OF THE INTERIOR  
BUREAU OF LAND MANAGEMENT  
ARIZONA STATE OFFICE  
ONE NORTH CENTRAL AVENUE, SUITE 800  
PHOENIX, AZ 85004-4427

PHOENIX ARIZONA

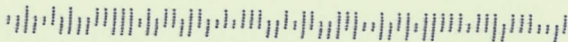



# United States Department of the Interior



BUREAU OF LAND MANAGEMENT  
Arizona State Office  
One North Central Avenue, Suite 800  
Phoenix, Arizona 85004-4427  
[www.blm.gov/az/](http://www.blm.gov/az/)

OCT 17 2017

In Reply Refer To:  
3800 (9200) RM  
AMC433776

CERTIFIED MAIL – RETURN RECEIPT REQUESTED 7017 0660 0000 3024 1065

## NOTICE

JEFFREY BLUM  
52 S BEVERLY LOT D13  
MESA, AZ 85210-8478

---

NICE AND EASY  
AMC433776

---

### Maintenance Fee Waiver Held for Rejection

This office received the Maintenance Fee Waiver Certification (waiver) for the above listed mining claim(s). The waiver is not properly completed and does not meet the annual filing requirements.

In accordance with 43 Code of Federal Regulations (CFR) 3835.10, the name, address, and original signatures of all owners of the mining claim must be included on the waiver form. Please correct the discrepancy as noted below:

- The document is missing claim owner names, addresses or signatures.
- Even if an agent is signing the waiver, the names and addresses of all claim owners are required to be listed on the waiver.
- Next to each name there must be a signature: either that of the owner, or an authorized agent.
- If an agent signs, they should identify themselves as signing on behalf of an owner. A Power of Attorney must accompany the waiver document. The execution date on the Power of Attorney must be current within 3 years.

In order to correct the defect in the waiver, per 43 CFR 3835.93, you must provide this office with the requested information within 60 days of your receipt of this notice. If you are unable to provide this information, you have the option of paying the annual maintenance fee of \$155 per claim (\$155 per 20 acres for placer claims larger than 20 acres). If we do not receive the requested corrections or the maintenance fees within the 60 day time frame, the claim(s) will be declared forfeited and closed.

Please include your AMC serial number on all correspondence. If additional information is required, please contact RéAnn Myers at 602-417-9413.

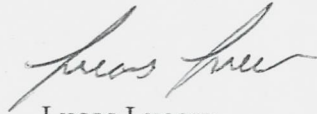

Lucas Lucero  
Deputy State Director  
Lands, Minerals and Energy Division

Enclosure(s)



**SENDER: COMPLETE THIS SECTION**

- Complete items 1, 2, and 3.
- Print your name and address on the reverse so that we can return the card to you.
- Attach this card to the back of the mailpiece, or on the front if space permits.

1. Addressee to:

DAVID LINDELL  
 550 N. ASPEN DR  
 CHANDLER, AZ 85226-2718  
 9200/RM/AMC433776



9590 9402 1932 6123 9273 73

2. Article Number (Transfer from service label)

7017 0660 0000 3024 1072

**COMPLETE THIS SECTION ON DELIVERY**

A. Signature

X

 Agent Addressee

B. Received by (Printed Name)

C. Date of Delivery

10/26/17

D. Is delivery address different from item 1?

 Yes

If YES, enter delivery address below:

 No

3. Service Type

 Adult Signature Adult Signature Restricted Delivery Certified Mail® Certified Mail Restricted Delivery Collect on Delivery Collect on Delivery Restricted Delivery Insured Mail Insured Mail Restricted Delivery

(over \$500)

 Priority Mail Express® Registered Mail™ Registered Mail Restricted Delivery Return Receipt for Merchandise Signature Confirmation™ Signature Confirmation Restricted Delivery

USPS TRACKING#

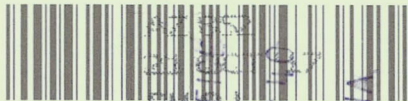

9590 9402 1932 6123 9293 73



First-Class Mail  
Postage & Fees Paid  
USPS  
Permit No. G-10

United States  
Postal Service

RECEIVED  
BLM AZ STATE OFFICE

2017 OCT 23 P 2:40

PHOENIX ARIZONA

• Sender: Please print your name, address, and ZIP+4® in this box •  
U.S. DEPARTMENT OF THE INTERIOR  
BUREAU OF LAND MANAGEMENT  
ARIZONA STATE OFFICE  
ONE NORTH CENTRAL AVENUE, SUITE 800  
PHOENIX, AZ 85004-4427

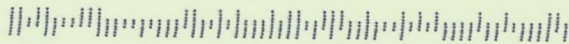



# United States Department of the Interior

BUREAU OF LAND MANAGEMENT

Arizona State Office

One North Central Avenue, Suite 800

Phoenix, Arizona 85004-4427

[www.blm.gov/az/](http://www.blm.gov/az/)

OCT 17 2017



In Reply Refer To:

3800 (9200) RM

AMC433776

CERTIFIED MAIL – RETURN RECEIPT REQUESTED 7017 0660 0000 3024 1072

## NOTICE

DAVID LINDELL

550 N ASPEN DR

CHANDLER, AZ 85226-2718

---

NICE AND EASY

AMC433776

---

### Maintenance Fee Waiver Held for Rejection

This office received the Maintenance Fee Waiver Certification (waiver) for the above listed mining claim(s). The waiver is not properly completed and does not meet the annual filing requirements.

In accordance with 43 Code of Federal Regulations (CFR) 3835.10, the name, address, and original signatures of all owners of the mining claim must be included on the waiver form. Please correct the discrepancy as noted below:

- The document is missing claim owner names, addresses or signatures.
- Even if an agent is signing the waiver, the names and addresses of all claim owners are required to be listed on the waiver.
- Next to each name there must be a signature: either that of the owner, or an authorized agent.
- If an agent signs, they should identify themselves as signing on behalf of an owner. A Power of Attorney must accompany the waiver document. The execution date on the Power of Attorney must be current within 3 years.

In order to correct the defect in the waiver, per 43 CFR 3835.93, you must provide this office with the requested information within 60 days of your receipt of this notice. If you are unable to provide this information, you have the option of paying the annual maintenance fee of \$155 per claim (\$155 per 20 acres for placer claims larger than 20 acres). If we do not receive the requested corrections or the maintenance fees within the 60 day time frame, the claim(s) will be declared forfeited and closed.

Please include your AMC serial number on all correspondence. If additional information is required, please contact RéAnn Myers at 602-417-9413.

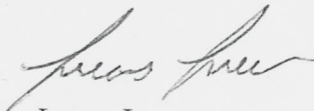

Lucas Lucero  
Deputy State Director  
Lands, Minerals and Energy Division

Enclosure(s)

**NOTICE!!**

**These documents have been scanned!**

**Do not place un-scanned documents beneath this notice!**

**Do not remove this notice from this file!**

GPO Jacket No. 560-102  
Print Order 61540  
Rise Business Services, LLC  
Job=AZ15 5/8/2019



Box Number= AZ15024



Claim Begin-End: AMC433776-AMC433776

3 Transfers



AZ15024-27

AMC433502-AMC433786

**NO  
DOCUMENTS  
FOUND**

NO DOCUMENTS FOUND  
NO DOCUMENTS FOUND

**NOTICE!!**

**These documents have been scanned!**

**Do not place un-scanned documents beneath this notice!**

**Do not remove this notice from this file!**

GPO Jacket No. 560-102  
Print Order 61540  
Rise Business Services, LLC  
Job=AZ15 5/8/2019



Box Number= AZ15024



Claim Begin-End: AMC433776-AMC433776

4 Annual Filings



AZ15024-27

AMC433502-AMC433786

433776

UNITED STATES  
DEPARTMENT OF THE INTERIOR  
BUREAU OF LAND MANAGEMENT  
**MAINTENANCE FEE WAIVER CERTIFICATION**

~~103~~  
103  
EAG

FORM APPROVED  
OMB NO. 1004-0114  
Expires: January 31, 2020

SEE INSTRUCTIONS ON PAGE 2 2019

2020

1. This small miner waiver is filed for the assessment year beginning on September 1, ~~2018~~ and ending on September 1, ~~2019~~.
2. The undersigned and all related parties owned ten or fewer mining claims, mill, or tunnel sites located and maintained on Federal lands in the United States of America on September 1, ~~2018~~ 2019.
3. The undersigned have performed the assessment work required by law for each mining claim listed prior to filing this waiver and understand that by filing this form, the undersigned must file an affidavit of assessment work with the Bureau of Land Management (BLM) by the December 30th following the filing of this waiver.
4. The undersigned understand that if the assessment work obligation has not yet come due under 30 U.S.C. 28 (for those claims in their first assessment year only), a notice of intent to hold reciting this condition must be recorded by the December 30th following the filing of this waiver.
5. The undersigned understand that mill and tunnel sites may also be listed on this waiver and be waived from payment of the maintenance fee, and that a notice of intent to hold for these sites is required to be filed with the BLM by the December 30th following the filing of this waiver.
6. The undersigned understand and acknowledge that pursuant to 43 U.S.C. 1212 and 18 U.S.C. 1001, the filing or recording of a false, fictitious, or fraudulent document with the BLM may result in a fine of up to \$250,000, a prison term not to exceed five years, or both.
7. The mining claims, mill or tunnel sites for which this waiver from payment of the maintenance fees is requested are:

CLAIM OR SITE NAME	BLM RECORDATION SERIAL NUMBER
1. NICE AND EASY ✓	AMEC 433776
2.	
3.	
4.	
5.	
6.	
7.	
8.	
9.	
10.	

The owner(s) (claimants) of the above mining claims and sites are:

JEFFREY BLUM

(Owner's Name - Please Print)

52 S. BEVERLY Lot D #13

(Owner's Mailing Address)

*Jeffrey Blum*

(Owner's Signature)

Mesa

(City)

AZ, 85210

(State)

(Zip Code)

(Owner's Name - Please Print)

(Owner's Signature)

(Owner's Mailing Address)

(City)

(State)

(Zip Code)

(Owner's Name - Please Print)

(Owner's Signature)

(Owner's Mailing Address)

PHOENIX, ARIZONA

(City)

(State)

(Zip Code)

(Owner's Name - Please Print)

(Owner's Signature)

(Owner's Mailing Address)

RECEIVED STATE OFFICE

(City)

(State)

(Zip Code)

(Continued on page 2)

ENTERED  
SEP 06 2019  
BY: *[Signature]*

2019 AUG -1 P 3:09

NW 1 claim  
*[Signature]*



(Owner's Name - Please Print)	(Owner's Signature)		
(Owner's Mailing Address)	(City)	(State)	(Zip Code)
(Owner's Name - Please Print)	(Owner's Signature)		
(Owner's Mailing Address)	(City)	(State)	(Zip Code)
(Owner's Name - Please Print)	(Owner's Signature)		
(Owner's Mailing Address)	(City)	(State)	(Zip Code)
(Owner's Name - Please Print)	(Owner's Signature)		
(Owner's Mailing Address)	(City)	(State)	(Zip Code)

18 U.S.C. 1001 and 43 U.S.C. 1212 make it a crime for any person knowingly and willfully to make to any department or agency of the United States any false, fictitious or fraudulent statements or representations as to any matter within its jurisdiction.

**INSTRUCTIONS**

1. This certification is made under the provisions of 43 U.S.C. § 1744 and 30 U.S.C. §28-28k and the regulations thereunder (43 CFR Part 3830).
2. The claimant(s) must fill in the dates in paragraph 1 for the beginning and ending of the assessment year for which this waiver is sought.
3. The claimant(s) must fill in the date in paragraph 2 for the beginning of the assessment year for which this waiver is sought.
4. All claim and site names and BLM serial numbers must be listed for the mining claims, mill sites, and tunnel sites for which the waiver is sought.
5. All owners of the mining claims, mill sites, and tunnel sites and their addresses must be given.
6. This waiver form must be signed by all the claimants or their designated agent, in original form. If an agent is designated, a notarized designation of agent, signed by all of the claimants with proper address given, must be submitted with this waiver.
7. This form must be filed no later than September 1st for the upcoming assessment year in the BLM State Office where the mining claims or sites are recorded, or the waiver cannot be granted by the BLM. (Example: To obtain a waiver for the assessment year 2012, which begins on September 1, 2011, you must qualify for and file for a waiver no later than September 1, 2011, in the proper BLM State Office.)
8. For all mining claims which require assessment work, you must record an affidavit of labor on or before the December 30th immediately following the filing of this waiver. For all other mining claims or sites waived, you must record a notice of intent to hold on or before the December 30th immediately following the filing of this waiver.
9. Mill and tunnel sites may also be listed on this waiver and be waived from payment of the maintenance fee. A notice of intent to hold for these sites is required to be filed by the December 30th following the filing of this waiver.

PHOENIX, ARIZONA  
 1100 1091  
 RECEIVED  
 STATE OFFICE  
 2019 AUG 17 10 09 AM  
 OFFICIAL USE ONLY

180

HER

433776

MAINTENANCE FEE WAIVER CERTIFICATION

FORM APPROVED  
OMB NO. 1004-0114  
Expires: January 31, 2020

SEE INSTRUCTIONS ON PAGE 2

1. This small miner waiver is filed for the assessment year beginning on September 1, 2018 and ending on September 1, 2019
2. The undersigned and all related parties owned ten or fewer mining claims, mill, or tunnel sites located and maintained on Federal lands in the United States of America on September 1, 2018.
3. The undersigned have performed the assessment work required by law for each mining claim listed prior to filing this waiver and understand that by filing this form, the undersigned must file an affidavit of assessment work with the Bureau of Land Management (BLM) by the December 30th following the filing of this waiver.
4. The undersigned understand that if the assessment work obligation has not yet come due under 30 U.S.C. 28 (for those claims in their first assessment year only), a notice of intent to hold reciting this condition must be recorded by the December 30th following the filing of this waiver.
5. The undersigned understand that mill and tunnel sites may also be listed on this waiver and be waived from payment of the maintenance fee, and that a notice of intent to hold for these sites is required to be filed with the BLM by the December 30th following the filing of this waiver.
6. The undersigned understand and acknowledge that pursuant to 43 U.S.C. 1212 and 18 U.S.C. 1001, the filing or recording of a false, fictitious, or fraudulent document with the BLM may result in a fine of up to \$250,000, a prison term not to exceed five years, or both.
7. The mining claims, mill or tunnel sites for which this waiver from payment of the maintenance fees is requested are:

CLAIM OR SITE NAME	BLM RECORDATION SERIAL NUMBER
1. NICE AND EASY	<del>AME 433776</del> AME 433776 (913)
2.	
3.	
4.	
5.	
6.	
7.	
8.	
9.	
10.	

The owner(s) (claimants) of the above mining claims and sites are:

1 of JEFFREY Blum  
(Owner's Name - Please Print)  
52 S. BEVERLY Lot D13 ✓  
(Owner's Mailing Address)

*[Signature]*  
(Owner's Signature)  
MESA AZ 85210  
(City) (State) (Zip Code)

(Owner's Name - Please Print)  
(Owner's Mailing Address)

(Owner's Signature)  
(City) (State) (Zip Code)

(Owner's Name - Please Print)  
(Owner's Mailing Address)

(Owner's Signature)  
(City) (State) (Zip Code)

(Owner's Name - Please Print)  
(Owner's Mailing Address)

(Owner's Signature)  
(City) (State) (Zip Code)

AC 48-3  
ENTERED SEP 05 2018  
PB

RECEIVED  
BLM AZ STATE OFFICE  
2018 AUG 13 AM 11:22  
PHOENIX, ARIZONA

new/pb

(Owner's Name - Please Print)	(Owner's Signature)
(Owner's Mailing Address)	(City) (State) (Zip Code)
(Owner's Name - Please Print)	(Owner's Signature)
(Owner's Mailing Address)	(City) (State) (Zip Code)
(Owner's Name - Please Print)	(Owner's Signature)
(Owner's Mailing Address)	(City) (State) (Zip Code)
(Owner's Name - Please Print)	(Owner's Signature)
(Owner's Mailing Address)	(City) (State) (Zip Code)

---

18 U.S.C. 1001 and 43 U.S.C. 1212 make it a crime for any person knowingly and willfully to make to any department or agency of the United States any false, fictitious or fraudulent statements or representations as to any matter within its jurisdiction.

---

**INSTRUCTIONS**

1. This certification is made under the provisions of 43 U.S.C. § 1744 and 30 U.S.C. §28-28k and the regulations thereunder (43 CFR Part 3830).
2. The claimant(s) must fill in the dates in paragraph 1 for the beginning and ending of the assessment year for which this waiver is sought.
3. The claimant(s) must fill in the date in paragraph 2 for the beginning of the assessment year for which this waiver is sought.
4. All claim and site names and BLM serial numbers must be listed for the mining claims, mill sites, and tunnel sites for which the waiver is sought.
5. All owners of the mining claims, mill sites, and tunnel sites and their addresses must be given.
6. This waiver form must be signed by all the claimants or their designated agent, in original form. If an agent is designated, a notarized designation of agent, signed by all of the claimants with proper address given, must be submitted with this waiver.
7. This form must be filed no later than September 1st for the upcoming assessment year in the BLM State Office where the mining claims or sites are recorded, or the waiver cannot be granted by the BLM. (Example: To obtain a waiver for the assessment year 2012, which begins on September 1, 2011, you must qualify for and file for a waiver no later than September 1, 2011, in the proper BLM State Office.)
8. For all mining claims which require assessment work, you must record an affidavit of labor on or before the December 30th immediately following the filing of this waiver. For all other mining claims or sites waived, you must record a notice of intent to hold on or before the December 30th immediately following the filing of this waiver.
9. Mill and tunnel sites may also be listed on this waiver and be waived from payment of the maintenance fee. A notice of intent to hold for these sites is required to be filed by the December 30th following the filing of this waiver.

*FOR OFFICIAL USE ONLY*

When Recorded Return Document to:

AMC 433776

\_\_\_\_\_  
\_\_\_\_\_  
\_\_\_\_\_

Check here is this is a change of address.

Telephone: \_\_\_\_\_

E-mail address: \_\_\_\_\_

**AFFIDAVIT OF PERFORMANCE OF ANNUAL WORK**

1. State of Arizona, County of MARICOPA ss:

2. I (Name) JEFFREY BLUM

3. Reside at (Address) S2. S. BEVERLY

LOT D 13

City MESA County MARICOPA

RECEIVED  
BLM AZ STATE OFFICE  
2018 AUG 13 A 11:23  
PHOENIX, ARIZONA  
BLM  
Date  
Stamp

State AZ Zip 85210 being duly sworn, depose and say that I am a citizen of the United States, more than eighteen years of age, and that all of the facts set forth in this affidavit, subject to the provisions and penalties of 18 U.S.C. 1001 pertaining to the filing of false, fictitious, or fraudulent statements with the United States, are true and correct according to the best of my knowledge, information and belief.

4. Owner's name and address (If not shown in Items 1-3 above). \_\_\_\_\_

5. That I am personally acquainted with the mining claim(s). The work and improvements were made by and at the expense of the owner(s) of said claim(s). Said contiguous group of claims, listed on this document, are situated in the

\_\_\_\_\_ (optional) Mining District; \_\_\_\_\_ County, Arizona.

Line No.	AMC NUMBER	CLAIM/SITE NAME	COUNTY RECORDER DATA (If available)	TWP	RNG	SEC
1	AMC 433776	NICE AND EASY		36	11N	1E
2						
3						
4						
5						
6						

Form: MCF108  
Revised July 2014  
Page 1 of 2

ENTERED  
AUG 20 2018  
BY: [Signature]

RECEIVED  
BLM AZ STATE OFFICE  
2018 AUG 13 A 11:23  
PHOENIX, ARIZONA  
BLM  
Date  
Stamp

7					
8					
9					
10					

6. That between the dates starting at 12 o'clock noon on September 1, 20 17 and ending at 12 o'clock noon on September 1, 20 18 at least \$ 100 dollars worth of work and improvements were done and performed upon said claim(s) or upon one or more of a contiguous group of claims for the benefit of all, wholly or partly outside of a contiguous group of claims for the benefit of all, not including the location work.

7. That the following persons were employed to perform the work and improvements described herein: JEFFREY BLUM

8. That the work and improvements performed were: THE ROAD TO THE CLAIM WAS IMPROVED BY FILLING IN HOLES, PORTALING RUN OFF AREAS AND THE ROAD WAS EXTENDED A QUARTER OF A MILE USING SHOVEL AND MUSCLES AT \$10/hr

9. Dated: Aug 13, 2018 Signature: [Signature]

SUBSCRIBED AND SWORN TO before me, a Notary Public, this 13 day of Aug. 20 18

By: Jeffrey Blum

Notary Public Maria Tichy

My Commission Expires 03/30/2020

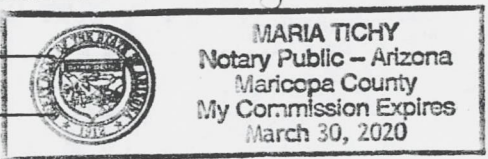

Bureau of Land Management  
Arizona State Office  
[www.blm.gov/az](http://www.blm.gov/az)

No. of Claims: 1 x \$10 = 10<sup>00</sup>  
Check No.: \_\_\_\_\_ Init. PER  
Receipt No.: 4233235  
For BLM Use Only

DATE: June 11<sup>th</sup> 2018

TIME STARTED WORK: 7:30 AM

1 hr @ \$10/hr

TIME FINISHED WORK: 8:00 AM

WORK DESCRIPTION: The bottom section of the road were

~~several~~ several long depressions. ~~Now to~~ More rocks were needed to fill them. The rocks were placed on top and some fell between the rocks to lock them in place. It is going to rain in a day or two. Then ~~the~~ the dirt will fill in the ~~the~~ holes. Looks good and will own repair. Please come to work it down to a more permanent solution to the repair. (June 11<sup>th</sup> drove over repairs after rain and cementation into place.)

DATE: Friday, June 15<sup>th</sup> 2018

TIME STARTED WORK: 6:30 AM

2 hrs @ \$10/hr

TIME FINISHED WORK: 8:30 AM

WORK DESCRIPTION: REPAIRED ANOTHER 100ft up the mountain

ROAD There were several long depressions that took a good amount of rock to fill them to the level of the road, then dirt was added the same method as yesterday.

Now after being driven on the rock will lock together leaving a small depression which will have to be filled to the road level once again with dirt added. Then the repair work should be complete.

DATE: ~~Jan~~ Sunday, June 17<sup>th</sup> 2018

TIME STARTED WORK: 12:30 AM

45 minutes

TIME FINISHED WORK: 1:15 AM

\$15/hr

WORK DESCRIPTION: Bedrock was jutting up by the road. The area

surrounding the bedrock was raised to the level of the jutting bedrock. It is on a sharp turn and a steep grade. It should be a good repair that will last for some time.

# Assesment Work

Sunday, August 13, 2017

12:03 PM

\$10.00/hr

DATE: July 21<sup>st</sup>, 2018

TIME STARTED WORK: 7:55 PM - 8:55 - 1 hr

TIME FINISHED WORK: 8:55 pm

WORK DESCRIPTION: Being away from the CLAIM for 2 weeks I wasn't able to keep up with the road maintenance. 4 wheelers come and go causing minor ROAD damage. If the damage isn't repaired it keeps getting worse, so I spent an hour working on ~~fill~~ leveling out several places adding rocks & dirt to several others. I only covered a little over a 1/3 of the ROAD starting at the bottom of the mountain.

DATE: July 22<sup>nd</sup>, 2018

\$10/hr

TIME STARTED WORK: 7:30 PM - 1 1/2 hr

TIME FINISHED WORK: 9:00 PM

WORK DESCRIPTION: One section of the ROAD has small pieces of rocks that doesn't hold when a vehicle ~~drives~~ drives over it. Part of it was removed and dirt was added as a base for it to sink into and it would hold better when a TRX passes over it. Several more places were leveled out from the 4 wheelers ~~causing~~ damage.

PHOENIX, ARIZONA

2018 AUG 13 A 11:23

RECEIVED  
BLM AZ STATE OFFICE

DATE:

TIME STARTED WORK:

DATE: 3/18/18 Sun, March 18th 2018  
TIME STARTED WORK: 1:30  
TIME FINISHED WORK: 2:40  
Line 5000

WORK DESCRIPTION: Added several more bags of rocks to a section of the road that drops down ~~from~~ on one side. The collection of smaller rocks to lay down on top of the ~~larger~~ larger rocks does nicely in filling in the empty ~~spaces~~ spaces and tying the rocks together, so far several ~~been~~ storms have gone through and none have washed out.

DATE: 4/2 TRIBU 2018

TIME STARTED WORK: 11:00 AM \$10/hr  
1 hour 30 minutes

TIME FINISHED WORK: 12:30 PM

WORK DESCRIPTION: It took time to find rocks and collect them, then left in a bag to carry to the road. This time I collected 12 bags of rocks and completed a section of the road that had a hole and a dip in it. Now it has a solid ramp of rocks from the four bags of 100 rocks each.

DATE: 5/18 Friday

TIME STARTED WORK: 7:30 AM \$10/hr

2 hours

TIME FINISHED WORK: 9:30 AM

WORK DESCRIPTION: This section of the road has never been maintained for many years. I'm starting repairs today to be able to drive closer to the claim. It has sections that need to be filled, other parts need to be leveled due to rock slides. Today I'll be filling in places where the rains have washed out.

- Filled in several deep holes from a section approx. 500 ft long.

Now it is drivable!



At \$10.00/hour

RECEIVED  
RIM AZ STATE OFFICE

2018 AUG 13 A 11:23

PHOENIX, ARIZONA

DATE: Sunday, Feb 11, 2018

TIME STARTED WORK: 8:02 AM

TIME FINISHED WORK: 9:05 AM

= 1 hour

WORK DESCRIPTION: Filling a depression in the Road To the mine. The next couple of days it will rain, with the depression half full of various size rocks the runoff from the rain will fill in the voids between the rocks to make a more permanent base to build upon in the future

DATE: TUESDAY Feb 13th 2018

TIME STARTED WORK: 9:15 AM

TIME FINISHED WORK: 10:30 AM

1 hour 15 minutes

WORK DESCRIPTION: A road was built a road was built in the area. Rocks were placed in the road to fill in the voids between the rocks to make a more permanent base to build upon in the future.

**United States Department of the Interior  
Bureau of Land Management  
DIV OF LANDS, MINRLS & ENERGY  
ONE N CENTRAL AVE  
PHOENIX, AZ 85004 -4427  
Phone: 602-417-9200**

Receipt

No: 4233235

<b>Transaction #:</b> 4348575	
<b>Date of Transaction:</b> 08/13/2018	
<b>CUSTOMER:</b>	
JEFFREY BLUM 52 S BEVERLY LOT D13 MESA, AZ 85210-8451 US	

LINE #	QTY	DESCRIPTION	REMARKS	UNIT PRICE	TOTAL
1	1.00	LOCATABLE MINERALS / MINING CLAIMS-NOT NEW-UNADJUD, ONE AUTH NO. ONLY / MINING CLAIM MONEY RECEIVED CASES: AMC433776/\$10.00	2018POL/1 AND WAIVER	- n/a -	10.00
<b>TOTAL:</b>					<b>\$10.00</b>

PAYMENT INFORMATION			
NOTE: Items will appear on credit card statement as "Bureau of Land Mgmt CO".			
1	AMOUNT:	10.00	POSTMARKED: N/A
	TYPE:	CREDIT CARD	RECEIVED: 08/13/2018
	NAME:	BLUM, JEFFREY 52 S BEVERLY LOT D13 MESA AZ 85210-8451 US	
	CARD NO:	XXXXXXXXXXXX7850	AUTH CODE: 013647
	NAME ON CARD:	JEFFREY M BLUM	
	SIGNATURE:		

REMARKS

This receipt was generated by the automated BLM Collections and Billing System and is a paper representation of a portion of the official electronic record contained therein.

UNITED STATES  
DEPARTMENT OF THE INTERIOR  
BUREAU OF LAND MANAGEMENT  
**MAINTENANCE FEE WAIVER CERTIFICATION**

4771  
[Signature]

Amc 433776

FORM APPROVED  
OMB NO. 1004-0114  
Expires: January 31, 2020

SEE INSTRUCTIONS ON PAGE 2

1. This small miner waiver is filed for the assessment year beginning on September 1, 2017 and ending on September 1, 2018.
2. The undersigned and all related parties owned ten or fewer mining claims, mill, or tunnel sites located and maintained on Federal lands in the United States of America on September 1, 2017.
3. The undersigned have performed the assessment work required by law for each mining claim listed prior to filing this waiver and understand that by filing this form the undersigned must file an affidavit of assessment work with the Bureau of Land Management (BLM) by the December 30th following the filing of this waiver.
4. The undersigned understand that if the assessment work obligation has not yet come due under 30 U.S.C. 28 (for those claims in their first assessment year only), a notice of intent to hold reciting this condition must be recorded by the December 30th following the filing of this waiver.
5. The undersigned understand that mill and tunnel sites may also be listed on this waiver and be waived from payment of the maintenance fee, and that a notice of intent to hold for these sites is required to be filed with the BLM by the December 30th following the filing of this waiver.
6. The undersigned understand and acknowledge that pursuant to 43 U.S.C. 1212 and 18 U.S.C. 1001, the filing or recording of a false, fictitious, or fraudulent document with the BLM may result in a fine of up to \$250,000, a prison term not to exceed five years, or both.
7. The mining claims, mill or tunnel sites for which this waiver from payment of the maintenance fees is requested are:

CLAIM OR SITE NAME	BLM RECORDATION SERIAL NUMBER
1. <u>Amc 4 NICE AND EASY</u> ✓	<u>Amc 433776</u>
2.	
3.	
4.	
5.	
6.	
7.	
8.	
9.	
10.	

The owner(s) (claimants) of the above mining claims and sites are:

JEFFREY Blum  
(Owner's Name - Please Print)  
52 S. Beverly Lot D13  
(Owner's Mailing Address)

[Signature]  
(Owner's Signature)  
MESA AZ 85210  
(City) (State) (Zip Code)

(Owner's Name - Please Print)

(Owner's Signature)

(Owner's Mailing Address)

(City)

(State)

(Zip Code)

(Owner's Name - Please Print)

(Owner's Signature)

(Owner's Mailing Address)

(City)

(State)

(Zip Code)

(Owner's Name - Please Print)

(Owner's Signature)

(Owner's Mailing Address)

(City)

(State)

(Zip Code)

(Continued on page 2)

PHOENIX, ARIZONA

ENTERED  
SEP 13 2017

2017 AUG 30 9:41

RECEIVED  
BLM STATE OFFICE

12/19/17 REINVESTMENT OF  
DAVID LOUDELL'S RIGHT CURES  
WAIVER. FM

WWU

(Owner's Name - Please Print)

(Owner's Signature)

(Owner's Mailing Address)

(City)

(State)

(Zip Code)

(Owner's Name - Please Print)

(Owner's Signature)

(Owner's Mailing Address)

(City)

(State)

(Zip Code)

(Owner's Name - Please Print)

(Owner's Signature)

(Owner's Mailing Address)

(City)

(State)

(Zip Code)

(Owner's Name - Please Print)

(Owner's Signature)

(Owner's Mailing Address)

(City)

(State)

(Zip Code)

18 U.S.C. 1001 and 43 U.S.C. 1212 make it a crime for any person knowingly and willfully to make to any department or agency of the United States any false, fictitious or fraudulent statements or representations as to any matter within its jurisdiction.

INSTRUCTIONS

1. This certification is made under the provisions of 43 U.S.C. § 1744 and 30 U.S.C. §28-28k and the regulations thereunder (43 CFR Part 3830).
2. The claimant(s) must fill in the dates in paragraph 1 for the beginning and ending of the assessment year for which this waiver is sought.
3. The claimant(s) must fill in the date in paragraph 2 for the beginning of the assessment year for which this waiver is sought.
4. All claim and site names and BLM serial numbers must be listed for the mining claims, mill sites, and tunnel sites for which the waiver is sought.
5. All owners of the mining claims, mill sites, and tunnel sites and their addresses must be given.
6. This waiver form must be signed by all the claimants or their designated agent, in original form. If an agent is designated, a notarized designation of agent, signed by all of the claimants with proper address given, must be submitted with this waiver.
7. This form must be filed no later than September 1st for the upcoming assessment year in the BLM State Office where the mining claims or sites are recorded, or the waiver cannot be granted by the BLM. (Example: To obtain a waiver for the assessment year 2012, which begins on September 1, 2011, you must qualify for and file for a waiver no later than September 1, 2011, in the proper BLM State Office.)
8. For all mining claims which require assessment work, you must record an affidavit of labor on or before the December 30th immediately following the filing of this waiver. For all other mining claims or sites waived, you must record a notice of intent to hold on or before the December 30th immediately following the filing of this waiver.
9. Mill and tunnel sites may also be listed on this waiver and be waived from payment of the maintenance fee. A notice of intent to hold for these sites is required to be filed by the December 30th following the filing of this waiver.

FOR OFFICIAL USE ONLY

PHOENIX, ARIZONA

2017 AUG 30 A 9:47

RECEIVED  
BLM AZ STATE OFFICE

Dec 18, 2017.

To Whom It May Concern,

I am David Lindell's sister and closest living relative. I know David would have wanted his friend Pete Blum to have his share of the gold claim in Arizona.

I relinquish all interest in the claim and would like for it to be in Pete's name only.

Thank you very much.

Carol M Gordon 12-18-17

Carol M Gordon

(David Luke Lindell's sister)

State of Oregon )  
County of Deschutes )  
On this 18 day of December, in the  
Year of 2017, before me personally appeared  
Carol M Gordon, personally known  
to me whose identity has proved to me on the basis of  
satisfactory evidence to be the person whose name is  
subscribed to this instrument, and acknowledged that  
he/she executed it.

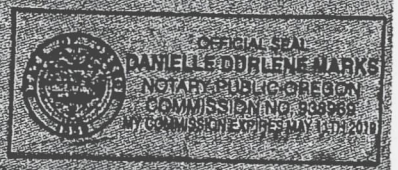

WITNESS my hand and official seal

*[Signature]*  
Notary Public

My Commission Expires: May 1, 2019

FOR AMC 433776

93 ENTERED  
DEC 19 2017  
BY: for

RECEIVED  
STATE OFFICE  
2017 DEC 18 P 3:34  
PHOENIX, ARIZONA

# STATE OF ARIZONA

## CERTIFICATION OF VITAL RECORD

### STATE OF ARIZONA DEPARTMENT OF HEALTH SERVICES - OFFICE OF VITAL RECORDS CERTIFICATE OF DEATH

State File NO. 102- 2016-051833

1. DECEDENT'S LEGAL NAME (FIRST, MIDDLE, LAST) <b>DAVID LUKE LINDELL</b>			2. AKA'S (IF ANY)			3. DATE OF DEATH <b>12/01/2016</b>				
4. SEX <b>MALE</b>	5. SOCIAL SECURITY NUMBER	6. DATE OF BIRTH <b>02/14/1958</b>	7. AGE <b>58</b>	8. MONTHS <b>UNDER 1 YEAR</b>		9. DAYS	10. HOURS <b>UNDER 1 DAY</b>		11. MINUTES	
12. PLACE OF DEATH - HOSPITAL: <input type="checkbox"/> INPATIENT <input type="checkbox"/> E.R./OUTPATIENT <input type="checkbox"/> DEAD ON ARRIVAL			13. PLACE OF DEATH - OTHER THAN HOSPITAL: <input type="checkbox"/> NURSING HOME OR LONG TERM CARE FACILITY <input checked="" type="checkbox"/> RESIDENCE <input type="checkbox"/> HOSPICE FACILITY <input type="checkbox"/> OTHER							
14. FACILITY NAME (OR STREET ADDRESS IF NOT A FACILITY): <b>52 S BEVERLY</b>				15. CITY, TOWN & ZIP CODE OR LOCATION OF DEATH <b>MESA 85210</b>			16. COUNTY OF DEATH: <b>MARICOPA</b>			
17. BIRTHPLACE (CITY AND STATE OR FOREIGN COUNTRY) <b>ZANESVILLE, OHIO</b>			18. MARITAL STATUS AT TIME OF DEATH <b>DIVORCED</b>			19. NAME OF SURVIVING SPOUSE (MAIDEN NAME IF WIFE)				
20. DECEDENT'S USUAL RESIDENCE STREET ADDRESS: <b>52 S BEVERLY</b>				21. CITY AND COUNTY <b>MESA, MARICOPA</b>		22. STATE <b>ARIZONA</b>		23. ZIP CODE <b>85210</b>		24. EVER IN THE ARMED FORCES <b>NO</b>
25. WAS DECEDENT OF HISPANIC ORIGIN? <input checked="" type="checkbox"/> NO, NOT SPANISH, HISPANIC OR LATINO <input type="checkbox"/> YES, MEXICAN, MEXICAN AMERICAN, CHICANO <input type="checkbox"/> YES, PUERTO RICAN <input type="checkbox"/> YES, CUBAN <input type="checkbox"/> YES, OTHER (SPECIFY)  <input type="checkbox"/> UNKNOWN			26. DECEDENT'S RACE(S): <input type="checkbox"/> WHITE <input type="checkbox"/> BLACK, AFRICAN AMERICAN <input type="checkbox"/> NATIVE HAWAIIAN <input type="checkbox"/> ASIAN INDIAN <input type="checkbox"/> CHINESE <input type="checkbox"/> FILIPINO <input type="checkbox"/> JAPANESE <input type="checkbox"/> GUAMANIAN OR CHAMORRO <input type="checkbox"/> KOREAN <input type="checkbox"/> VIETNAMESE <input type="checkbox"/> SAMOAN <input type="checkbox"/> AMERICAN INDIAN OR ALASKA NATIVE  <input type="checkbox"/> OTHER ASIAN (SPECIFY) <input type="checkbox"/> OTHER PACIFIC ISLANDER (SPECIFY) <input type="checkbox"/> OTHER (SPECIFY) <input type="checkbox"/> UNKNOWN			27. IF AMERICAN INDIAN OR ALASKA NATIVE SPECIFY UP TO 4 TRIBES, PRIMARY OR ENROLLED TRIBE.  ADDITIONAL TRIBE:  ADDITIONAL TRIBE:  ADDITIONAL TRIBE:				
28. OCCUPATION: <b>LABORER</b>			29. FATHER'S NAME (FIRST, MIDDLE, LAST) <b>MYRLE EVERETT LINDELL</b>			30. MOTHER'S NAME (FIRST, MIDDLE, & LAST NAME PRIOR TO FIRST MARRIAGE) <b>MAXINE GERALDINE DENMAN</b>				
31. INFORMANT'S NAME <b>CAROL MAXINE GORHAM</b>			32. RELATIONSHIP <b>SISTER</b>			33. INFORMANT'S MAILING ADDRESS: <b>52900 FOREST RD. LA PINE, OREGON 97739</b>				
34. NAME AND ADDRESS OF FUNERAL FACILITY: <b>MELDRUM MORTUARY 52 N MACDONALD, MESA, AZ</b>			35. FUNERAL DIRECTOR: <b>ERIC WILLIAMS, FUNERAL DIRECTOR</b>			36. LICENSE NUMBER: <b>F1527</b>				
37. METHOD(S) OF DISPOSITION <b>CREMATION</b>		38. NAME AND LOCATION OF 1st DISPOSITION FACILITY: <b>MELDRUM CREMATORY, MESA, ARIZONA</b>			39. NAME AND LOCATION OF 2nd DISPOSITION FACILITY: <b>NONE</b>					
<b>MEDICAL CERTIFICATION SECTION CAUSE OF DEATH PART I</b>										
IMMEDIATE CAUSE OF DEATH 40. A <b>CARDIOPULMONARY ARREST</b>					41. APPROXIMATE INTERVAL: <b>UNKNOWN</b>					
DUE TO OR AS A CONSEQUENCE OF: 42. B <b>ISCHEMIC CARDIOMYOPATHY</b>					43. APPROXIMATE INTERVAL: <b>UNKNOWN</b>					
DUE TO OR AS A CONSEQUENCE OF: 44. C <b>CORONARY ARTERY DISEASE</b>					45. APPROXIMATE INTERVAL: <b>UNKNOWN</b>					
DUE TO OR AS A CONSEQUENCE OF: 46. D					47. APPROXIMATE INTERVAL:					
<b>CAUSE OF DEATH PART II</b>										
48. OTHER SIGNIFICANT CONDITIONS CONTRIBUTING TO DEATH BUT NOT RESULTING IN THE UNDERLYING CAUSES GIVEN ABOVE: <b>PERIPHERAL VASCULAR DISEASE, DIABETES, MELLITUS, ESSENTIAL HYPERTENSION</b>					49. INJURY? <b>NO</b>	50. INJURY AT WORK? <b>NO</b>	51. MANNER OF DEATH <b>NATURAL DEATH</b>		52. TIME OF DEATH <b>2306</b>	
					53. WAS AN AUTOPSY PERFORMED? <b>NO</b>	54. WERE AUTOPSY FINDINGS AVAILABLE TO COMPLETE THE CAUSE OF DEATH?				
<b>CAUSE AND MANNER OF DEATH CERTIFICATION</b>										
<input checked="" type="checkbox"/> Certifying Physician/Nurse Practitioner/Physician's Assistant - To the best of my knowledge, death occurred due to the cause(s) and manner stated. <input type="checkbox"/> Medical Examiner/Tribal Law Enforcement Authority - On the basis of examination and/or investigation, in my opinion, death occurred at the time, date, and place, and due to the cause(s) and manner stated.					55. NAME OF PERSON COMPLETING CAUSE OF DEATH: <b>JEANETTE D. JICHA, FNP</b>			56. DATE CERTIFIED: <b>12/05/2016</b>		
57. CERTIFIER'S ADDRESS: <b>1705 W. MAIN ST., MESA, AZ 85201</b>					58. NAME OF REGISTRAR: <b>MICHELE CASTANEDA-MARTINEZ</b>			59. DATE REGISTERED: <b>12/08/2016</b>		

DATE ISSUED: 12/09/2016



This is a true certification of the facts on file with the Arizona Department of Health Services, Bureau of Vital Records, PHOENIX, ARIZONA.  
Revised 07/2016

*Krystal Colburn*  
**KRYSTAL COLBURN**  
ASSISTANT STATE REGISTRAR

J0055162

This copy not valid unless prepared on a form displaying the State Seal and impressed with the raised seal of the issuing agency.

**ARIZONA DEPARTMENT OF HEALTH SERVICES**

ANY ALTERATION OR ERASURE VOIDS THIS CERTIFICATE

2017 DEC 18 P 3:37

RECEIVED

When Recorded Return Document to:

433776

JEFFREY Blum  
52. S. Beverly LOT D B  
Mesa, AZ 85210

Check here if this is a change of address.

Telephone: 480-547-2314

E-mail address: peterinaky@yahoo.com

UPDATED  
8/30/17  
RAM

AFFIDAVIT OF PERFORMANCE OF ANNUAL WORK

1. State of Arizona, County of YAVAPAI <sup>MARICOPA</sup> ss:

2. I (Name) JEFFREY Blum

3. Reside at (Address) 52. S. Beverly  
Lot D B

City Mesa County MARICOPA

RECEIVED  
AZ STATE OFFICE  
2017 AUG 30 A 9:39  
PHOENIX, ARIZONA  
BLM  
Date  
Stamp

State AZ Zip 85210 being duly sworn, depose and say that I am a citizen of the United States, more than eighteen years of age, and that all of the facts set forth in this affidavit, subject to the provisions and penalties of 18 U.S.C. 1001 pertaining to the filing of false, fictitious, or fraudulent statements with the United States, are true and correct according to the best of my knowledge, information and belief.

4. Owner's name and address (If not shown in Items 1-3 above).

5. That I am personally acquainted with the mining claim(s). The work and improvements were made by and at the expense of the owner(s) of said claim(s). Said contiguous group of claims, listed on this document, are situated in the

(optional) Mining District; \_\_\_\_\_ County, Arizona.

Line No.	AMC NUMBER	CLAIM/SITE NAME	COUNTY RECORDER DATA (If available)	TWP	RNG	SEC
1	433776	Nice and Easy		11N	1E	36
2						
3						
4						
5						
6						

Form: MCF108  
Revised July 2014  
Page 1 of 2

ENTERED  
AUG 30 2017  
BY: RAM

RECEIVED  
BLM STATE OFFICE  
2017 AUG 30 A 9:39  
PHOENIX, ARIZONA

BLM  
Date  
Stamp

7					
8					
9					
10					

6. That between the dates starting at 12 o'clock noon on September 1, 20 16 and ending at 12 o'clock noon on September 1, 20 17 at least \$ 100 dollars worth of work and improvements were done and performed upon said claim(s) or upon one or more of a contiguous group of claims for the benefit of all, wholly or partly outside of a contiguous group of claims for the benefit of all, not including the location work.

7. That the following persons were employed to perform the work and improvements described herein: JEFFREY BLUM

8. That the work and improvements performed were: SEE ATTACHMENT  
ROAD MAINTENANCE AND CURBING WATER  
RUN OFF

9. Dated: Aug 16, 2017 Signature: Jeffrey M Blum

SUBSCRIBED AND SWORN TO before me, a Notary Public, this 29 day of Aug 20 17

By: JEFFREY BLUM

Notary Public Maria Tichy

My Commission Expires 03/30/2020

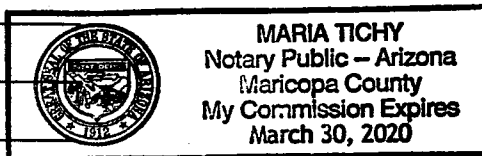

No. of Claims: 1 x \$10 = \$10.00  
 Check No.: Cash Init. EBG  
 Receipt No.: 3965555  
 For BLM Use Only

Bureau of Land Management  
Arizona State Office  
[www.blm.gov/az](http://www.blm.gov/az)



**United States Department of the Interior**  
**Bureau of Land Management**  
 DIV OF LANDS, MINRLS & ENERGY  
 ONE N CENTRAL AVE  
 PHOENIX, AZ 85004 -4427  
 Phone: 602-417-9200

Receipt

No: 3965555

<b>Transaction #:</b> 4075437	
<b>Date of Transaction:</b> 08/30/2017	
<b>CUSTOMER:</b>	
JEFFREY BLUM 52 S BEVERLY LOT D13 MESA, AZ 85210-8451 US	

LINE #	QTY	DESCRIPTION	REMARKS	UNIT PRICE	TOTAL
1	1.00	LOCATABLE MINERALS / MINING CLAIMS- NOT NEW-UNADJUD, ONE AUTH NO. ONLY / MINING CLAIM MONEY RECEIVED CASES: AMC433776/\$10.00	2017 POL & 2018 WAIVER (1)	- n/a -	10.00
<b>TOTAL:</b>					<b>\$10.00</b>

PAYMENT INFORMATION					
1	AMOUNT:	10.00	POSTMARKED:	N/A	
	TYPE:	CASH	RECEIVED:	08/30/2017	
	NAME:	BLUM, JEFFREY 52 S BEVERLY LOT D13 MESA AZ 85210-8451 US			

REMARKS

This receipt was generated by the automated BLM Collections and Billing System and is a paper representation of a portion of the official electronic record contained therein.

UNITED STATES  
DEPARTMENT OF THE INTERIOR  
BUREAU OF LAND MANAGEMENT  
**MAINTENANCE FEE WAIVER CERTIFICATION**

*Sept 1, 2016*

**433 776**

**154**

**RAM**

FORM APPROVED  
OMB NO. 1004-0114  
Expires: October 31, 2016

SEE INSTRUCTIONS ON PAGE 2

- This small miner waiver is filed for the assessment year beginning on September 1, 2016 and ending on September 1, 2017.
- The undersigned and all related parties owned ten or fewer mining claims, mill, or tunnel sites located and maintained on Federal lands in the United States of America on September 1, 2016.
- The undersigned have performed the assessment work required by law for each mining claim listed prior to filing this waiver and understand that by filing this form, the undersigned must file an affidavit of assessment work with the Bureau of Land Management (BLM) by the December 30th following the filing of this waiver.
- The undersigned understand that if the assessment work obligation has not yet come due under 30 U.S.C. 28 (for those claims in their first assessment year only), a notice of intent to hold reciting this condition must be recorded by the December 30th following the filing of this waiver.
- The undersigned understand that mill and tunnel sites may also be listed on this waiver and be waived from payment of the maintenance fee, and that a notice of intent to hold for these sites is required to be filed with the BLM by the December 30th following the filing of this waiver.
- The undersigned understand and acknowledge that pursuant to 43 U.S.C. 1212 and 18 U.S.C. 1001, the filing or recording of a false, fictitious, or fraudulent document with the BLM may result in a fine of up to \$250,000, a prison term not to exceed five years, or both.
- The mining claims, mill or tunnel sites for which this waiver from payment of the maintenance fees is requested are:

CLAIM OR SITE NAME	BLM RECORDATION SERIAL NUMBER
1. <u>Nice and Easy</u>	<u>AMC 433 776</u>
2.	
3.	
4.	
5.	
6.	
7.	
8.	
9.	
10.	

RECEIVED  
BLM AZ STATE OFFICE  
2016 JUN 15 A 10:04  
PHOENIX, ARIZONA

The owner(s) (claimants) of the above mining claims and sites are:

JEFFREY Blum  
(Owner's Name - Please Print)  
550 N ASPEN DE CHANDLER AZ  
(Owner's Mailing Address)

Jeffrey M. Blum  
(Owner's Signature)  
Chandler AZ 85226  
(City) (State) (Zip Code)

DAVID Lindell  
(Owner's Name - Please Print)  
525 BEVERLY DR  
(Owner's Mailing Address)

David Lindell  
(Owner's Signature)  
MESA AZ 85210  
(City) (State) (Zip Code)

\_\_\_\_\_  
(Owner's Name - Please Print)  
\_\_\_\_\_  
(Owner's Mailing Address)

\_\_\_\_\_  
(Owner's Signature)  
\_\_\_\_\_  
(City) (State) (Zip Code)

\_\_\_\_\_  
(Owner's Name - Please Print)  
\_\_\_\_\_  
(Owner's Mailing Address)

\_\_\_\_\_  
(Owner's Signature)  
\_\_\_\_\_  
(City) (State) (Zip Code)

(Continued on page 2)

**INTEREST**  
**433**  
**AUG 30 2016**  
BY: [Signature]

*NW*

2012-01-10

(Owner's Name - Please Print)

(Owner's Signature)

(Owner's Mailing Address)

(City) (State) (Zip Code)

(Owner's Name - Please Print)

(Owner's Signature)

(Owner's Mailing Address)

(City) (State) (Zip Code)

(Owner's Name - Please Print)

(Owner's Signature)

(Owner's Mailing Address)

(City) (State) (Zip Code)

(Owner's Name - Please Print)

(Owner's Signature)

(Owner's Mailing Address)

(City) (State) (Zip Code)

18 U.S.C. 1001 and 43 U.S.C. 1212 make it a crime for any person knowingly and willfully to make to any department or agency of the United States any false, fictitious or fraudulent statements or representations as to any matter within its jurisdiction.

INSTRUCTIONS

1. This certification is made under the provisions of 43 U.S.C. § 1744 and 30 U.S.C. §28-28k and the regulations thereunder (43 CFR Part 3830).
2. The claimant(s) must fill in the dates in paragraph 1 for the beginning and ending of the assessment year for which this waiver is sought.
3. The claimant(s) must fill in the date in paragraph 2 for the beginning of the assessment year for which this waiver is sought.
4. All claim and site names and BLM serial numbers must be listed for the mining claims, mill sites, and tunnel sites for which the waiver is sought.
5. All owners of the mining claims, mill sites, and tunnel sites and their addresses must be given.
6. This waiver form must be signed by all the claimants or their designated agent, in original form. If an agent is designated, a notarized designation of agent, signed by all of the claimants with proper address given, must be submitted with this waiver.
7. This form must be filed no later than September 1st for the upcoming assessment year in the BLM State Office where the mining claims or sites are recorded, or the waiver cannot be granted by the BLM. (Example: To obtain a waiver for the assessment year 2012, which begins on September 1, 2011, you must qualify for and file for a waiver no later than September 1, 2011, in the proper BLM State Office.)
8. For all mining claims which require assessment work, you must record an affidavit of labor on or before the December 30th immediately following the filing of this waiver. For all other mining claims or sites waived, you must record a notice of intent to hold on or before the December 30th immediately following the filing of this waiver.
9. Mill and tunnel sites may also be listed on this waiver and be waived from payment of the maintenance fee. A notice of intent to hold for these sites is required to be filed by the December 30th following the filing of this waiver.

FOR OFFICIAL USE ONLY

RECEIVED

\$ 10 Sept. 1, 2016

433776

**NOTICE OF INTENTION TO HOLD MINING CLAIMS/SITES**

When Recorded Return Document to:

\_\_\_\_\_  
\_\_\_\_\_  
\_\_\_\_\_

RECEIVED  
IN AZ STATE OFFICE  
2016 JUN 15 A 10:04  
YAVAPAI, ARIZONA  
BLM  
Date  
Stamp

Check here if this is a change of address.

Telephone: \_\_\_\_\_

E-mail Address: PETERINSKY@yahoo.com

I (We) intend to hold the claims(s) and/or site(s) listed below for the calendar year 20\_\_\_\_, and I (We) have filed or will file a Notice of Intent to Hold in the county where the claim (s) is located.

Reason for filing a Notice of Intent to Hold instead of an assessment work filing (check one):

- Maintenance fee was paid to maintain claim(s) during this assessment year.
- Mill or tunnel sites.
- Claim(s) was located during the current assessment year.
- BLM has deferred assessment work (attach copy of decision granting deferment, or pending petition for deferment including date petition was filed.)

Line No.	AMC NUMBER	CLAIM/SITE NAME	COUNTY RECORDER DATA (If available)	TWP	RNG	SEC
1	Amc 433776	Nice and Easy	YAVAPAI	11N	1E	36
2						
3						
4						
5						
6						
7						
8						
9						
10						

ENTERED  
JUN 16 2016  
BY: Ram

NOTICE OF INTENTION TO HOLD MINING CLAIMS/SITES  
page 2

BLM  
Date  
Stamp

RECEIVED  
MAY STATE OFFICE  
2016 JUN 15 A 10:06  
TUCSON, ARIZONA

1. State of Arizona, County of YAVAPAI  
2. I (Name) David Lindell  
3. Reside at (Address) 525 BEVELY DR TUCSON AZ 85710

City MESA County MARICOPA State AZ Zip 85210 being duly sworn, depose and say that I am a citizen of the United States, more than eighteen years of age, that all of the facts set forth in this notice, subject to the provisions and penalties of 18 U.S.C. 1001 pertaining to the filing of false, fictitious, or fraudulent statements with the United States, are true and correct according to the best of my knowledge, information and belief.

4. Owner's name and address (If not shown in Items 1-3 above). Delroy Blum  
550 N. Apache Dr Chandler AZ 85226

5. Dated: \_\_\_\_\_ Signature: [Signature]

Bureau of Land Management  
Arizona State Office  
[www.blm.gov/az](http://www.blm.gov/az)

No. of Claims: 1 x \$10 = 10<sup>0</sup>  
Check No: CASH Init. PETZ  
Receipt No.: 3585711  
For BLM Use Only

8105 8 1 MUL

**United States Department of the Interior**  
**Bureau of Land Management**  
 DIV OF LANDS, MINRLS & ENERGY  
 ONE N CENTRAL AVE  
 PHOENIX, AZ 85004 -4427  
 Phone: 602-417-9200

Receipt

No: 3585711

<b>Transaction #:</b> 3688799	
<b>Date of Transaction:</b> 06/15/2016	
CUSTOMER:	
JEFFREY BLUM 550 N ASPEN DR CHANDLER, AZ 85226-2718 US	

LINE #	QTY	DESCRIPTION	REMARKS	UNIT PRICE	TOTAL
1	1.00	LOCATABLE MINERALS / MINING CLAIMS- NOT NEW-UNADJUD, ONE AUTH NO. ONLY / MINING CLAIM MONEY RECEIVED CASES: AMC433776/\$10.00	2016 NOI HOLD/1	- n/a -	10.00
<b>TOTAL:</b>					<b>\$10.00</b>

PAYMENT INFORMATION			
1	AMOUNT:	10.00	POSTMARKED: N/A
	TYPE:	CASH	RECEIVED: 06/15/2016
	NAME:	BLUM, JEFFREY 550 N ASPEN DR CHANDLER AZ 85226-2718 US	

REMARKS

This receipt was generated by the automated BLM Collections and Billing System and is a paper representation of a portion of the official electronic record contained therein.

**NOTICE!!**

**These documents have been scanned!**

**Do not place un-scanned documents beneath this notice!**

**Do not remove this notice from this file!**

GPO Jacket No. 560-102  
Print Order 61540  
Rise Business Services, LLC  
Job=AZ15 5/8/2019



Box Number= AZ15024



Claim Begin-End: AMC433776-AMC433776

5 Miscellaneous



AZ15024-27

AMC433502-AMC433786

**NO  
DOCUMENTS  
FOUND**

NO DOCUMENTS FOUND  
NO DOCUMENTS FOUND



**NOTICE!!**

**These documents have been scanned!**

**Do not place un-scanned documents beneath this notice!**

**Do not remove this notice from this file!**

GPO Jacket No. 560-102  
Print Order 61540  
Rise Business Services, LLC  
Job=AZ15 5/8/2019



Box Number= AZ15024



Claim Begin-End: AMC433776-AMC433776

6 Location Notices-Amendments and Supporting Documents



AZ15024-27 AMC433502-AMC433786

**DEPARTMENT OF THE INTERIOR  
BUREAU OF LAND MANAGEMENT  
MINING CLAIMS**

Run Date/Time: 01/26/2016 03:40 PM

**(LIVE) Serial Register Page**

Page 1 of 1

01 05-10-1872;017STAT0091;30USC26,28,34

Case Type 384101: LODE CLAIM

Claim Name: NICE AND EASY

Commodity :

Case Disposition: ACTIVE

Required Maintenance Fee: \$155.00

Total Acres

16.530

Serial Number

AMC433776

Lead File Number

AMC433776

**Name & Address**

**Int Rel**

BOOM JEFFREY	550 N ASPEN DR	CHANDLER, AZ 85226-2718	CLAIMANT
HINDELL DAVID	550 N ASPEN DR	CHANDLER, AZ 85226-2718	CLAIMANT

Mer Twp	Rng	Sec	Quadrant	District/Field Office	County
14	011N	0010E	036 SW ,SE	HASSAYAMPA FO	YAVAPAI

Act Date	Code	Action	Action Remarks	Receipt Number
09/19/2015	403	LOCATION DATE		
09/23/2015	395	RECORDATION NOTICE RECD	1	3397649
09/23/2015	484	LOCATION YEAR / MAINTENANCE	2016;\$155	3397649
01/26/2016	669	LAND STATUS CHECKED		
09/23/2015	501	ACCT ADV IN LEAD FILE	AMC433776;	

**Line Nr Remarks**

# MINING CLAIM STATUS REPORT

Data Entered: 09/30/15 RM

MTP Checked By: [Signature]  
GEO Checked By: [Signature]

LEAD SERIAL NUMBER: AMC 433776 thru AMC \_\_\_\_\_

### NUMBER OF CLAIMS & TYPE:

1 LODE  
\_\_\_\_ PLACER  
\_\_\_\_ ASSOCIATION PLACER  
\_\_\_\_ MILL SITE  
\_\_\_\_ TUNNEL SITE

### CHARGES:

Location Fee @ \$37 = \$ 37  
Processing Fee @ \$20 = \$ 20  
Maintenance Fee @ \$155 = \$ 155  
Add'l Maint Fee for Assoc Placer = \$ \_\_\_\_\_  
SUBTOTAL \$ \_\_\_\_\_  
Other Fees \$ \_\_\_\_\_  
Other Fees \$ \_\_\_\_\_  
TOTAL \$ 212

TOTAL ACREAGE: \_\_\_\_\_ Per Claim  
(Placer Only)

NUMBER OF LOCATORS: \_\_\_\_\_

DOCUMENTS RECEIVED VIA : Over-the-Counter [  ] Mail [  ] TIMELY FILED: Yes [  ] No [  ]

LEGAL DESCRIPTION: T 11N R 1E SEC 36  
T \_\_\_\_\_ R \_\_\_\_\_ SEC \_\_\_\_\_  
T \_\_\_\_\_ R \_\_\_\_\_ SEC \_\_\_\_\_  
T \_\_\_\_\_ R \_\_\_\_\_ SEC \_\_\_\_\_  
T \_\_\_\_\_ R \_\_\_\_\_ SEC \_\_\_\_\_

BLM [  ] FOREST SERVICE [  ] Prescott SUBJ TO PL 359: Yes [  ] No [  ]  
WILDERNESS AREA [  ] \_\_\_\_\_

SPLIT ESTATE: N/A [  ] SX [  ] PX [  ] OTHER [  ] \_\_\_\_\_  
SRHA [  ] Was proper Notice filed if located on SHRA Land? Yes [  ] No [  ]

### RECONVEYED MINERALS ON BLM LAND REQUIRE OPENING ORDER FROM 1944 TO 1993:

Open to Entry On \_\_\_\_\_ N/A [  ]

COMMENTS/STATUS: VOID [  ] PARTIALLY VOID [  ] PVT MINERALS [  ] WITHDRAWN LANDS [  ]  
OTHER [  ] \_\_\_\_\_

AMC433776

[  ] Claimant acknowledges that portions of the following claim(s) site(s) may be void or voidable.

Printed Name of Claimant \_\_\_\_\_ Signature of Claimant \_\_\_\_\_

\*\*\*\*\*FINAL ADJUDICATION\*\*\*\*\*

DATE 1/26/16 INITIALS PR

**LOCATION NOTICE FOR LODE MINING CLAIM**

NOTICE IS HEREBY GIVEN that the Nice and  
Easy lode mining claim has been located  
by JEFFREY Blum whose current mailing  
address is 550 N. Aspen Drive  
Chandler, Az, 85226

RECEIVED  
BLM AZ STATE OFFICE  
2015 SEP 23 A 9:46  
PHOENIX, ARIZONA  
BLM  
Date  
Stamp

The general course of this claim is NW TO SE and it is situated in Yavapai  
County, Arizona. This claim is 1200 feet in length and 600 feet in width. This claim runs  
from the location monument on which this location notice is posted approximately 15 feet in a 16.53A  
NW direction to the NW end line and 1185 feet in a SE direction to the  
SE end line. This claim is marked by six monuments, one at each corner and one at the center of each  
end line of the claim.

The location monument on which this notice is posted is situated within Section 36, Township 11N  
1E, Range 1E, Gila Salt River Base and Meridian, Arizona and this claim encompasses portions  
of the following quarter section (s), section (s), Township (s) and Range (s) SW & SE 1/4, Section 36  
T11N R1E

Gila Salt River Base and Meridian, Arizona.

The locality of this claim with reference to some natural object or permanent monument and additional information  
(if any) concerning its locality are as follows: THERE IS A 14 FT BY 10 FT. NATURAL QUARTZ PILLAR.

THE NE CORNER MARKER IS A DISTANCE OF 652 FT FROM THE NATURAL OBJECT  
AND THE SE CORNER MARKER IS A DISTANCE OF 597 FT FROM THE SAME QUARTZ  
PILLAR

DATED AND POSTED on the ground this 19 day of September, 20 15.

LOCATOR (s) JEFFREY Blum David Lindell  
Jeffrey M Blum David Lindell

Form MCF100  
Revised July 2005

AMC433776

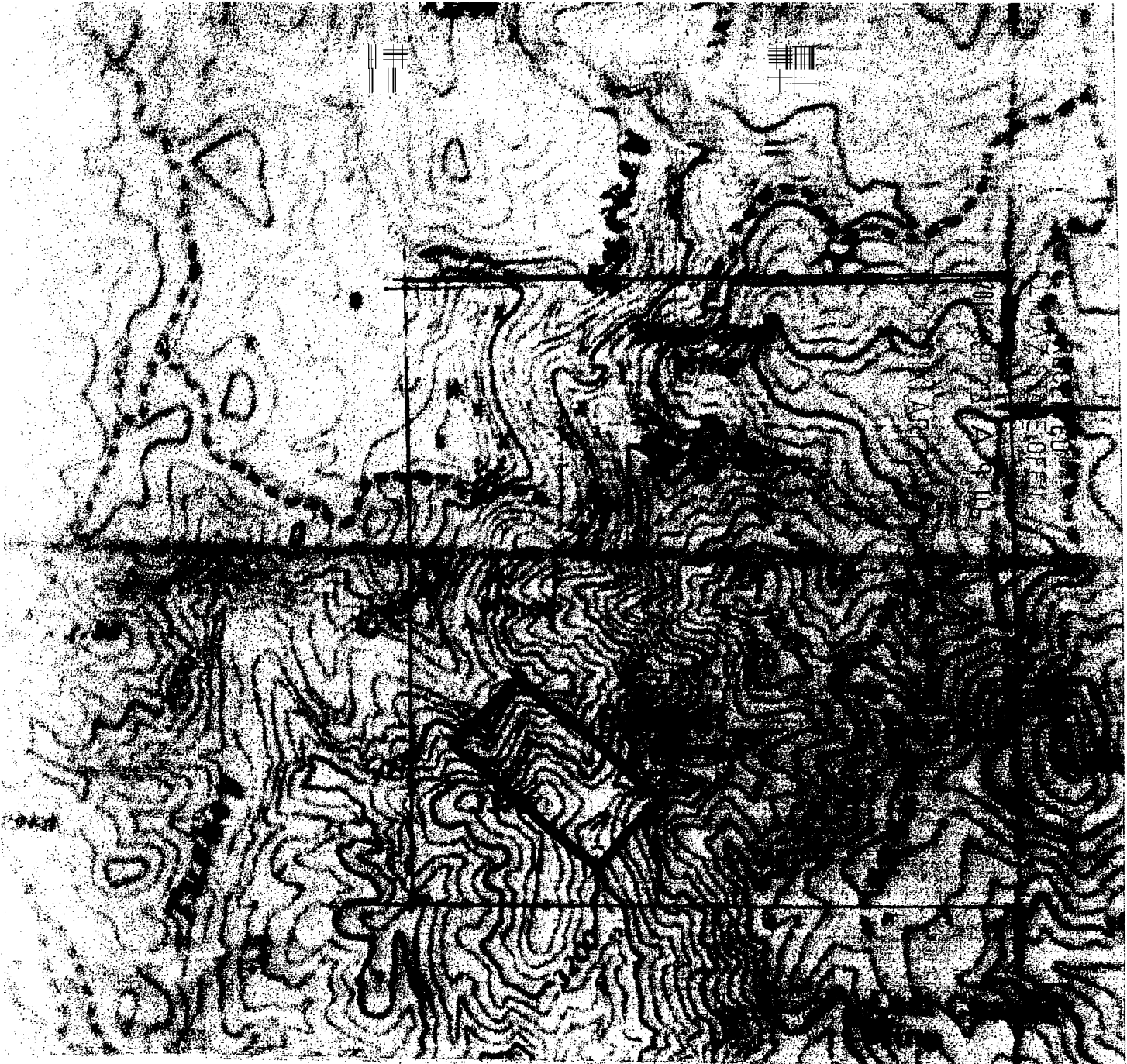

Scale : 1" = 2000 feet



1. The above map depicts the Nice and Easy mining claim, which is located in Section (s) 36, Township 11 N, Range 1 E, Gila and Salt River Base and Meridian, YAVAPAI County, Arizona.

2. The type of corner and location monuments used are as follows: 3/4 x 2 3/4 wood posts - painted redish-brown. PLACED AT EACH CORNER MONUMENT & Rm-line

3. The bearings and distances in degrees and feet between claim corners are as depicted on the map.

Form MCF100a  
Revised July 2005

This form is available from the Arizona Department of Mines & Mineral Resources and may be reproduced.

AMC433776

TOWNSHIP 11 NORTH RANGE 01 EAST OF THE GILA & SALT RIVER MERIDIAN, ARIZONA

SECS	SUBDIVISION																Acres	Kind of Entry or Purpose	Serial Number or Order Number	Action Date	Remarks				
	NE 1/4				NW 1/4				SW 1/4				SE 1/4									Lots	Other Description		
	NE	NW	SW	SE	NE	NW	SW	SE	NE	NW	SW	SE	NE	NW	SW	SE									
	For orders affecting disposal or use of unidentified lands withdrawn for classification, minerals, water, and/or other public purposes, and Indian treaties, refer to Index to Miscellaneous Documents																								
																		LOT 37 (MS);	10.502	PATENT / ME	2205	4/5/1877	MC 14;		
																		LOT 46 (MS);	20.09	PATENT / ME	11340	12/9/1886	MC 134;		
	ENTIRE TOWNSHIP																						PROC ENLGMT PRESCOTT FOREST RESERVE	10/21/1899	CHANGED TO PRESCOTT NF ACT 3/4/1907;
																		LOT 1463 (MS);	122.558	PATENT / ME	33876	4/6/1901	MC 407;		
																		LOT 1462 (MS);	187.176	PATENT / ME	34885	1/16/1902	MC 443;		
																		LOT 2138 (MS);	146.695	PATENT / ME	44530	10/20/1906	MC 150; OTHER TPS: 11N 2E, 10N 2E;		
																		LOT 2351 (MS);	20.578	PATENT / ME	45786	3/27/1907	MC 287;		
																		ALL SECS 2, 16, 32, 36;		STATE GRANT	ACT OF CONGRESS	6/20/1910	TITLE TO STATE TO FIX ON APPROVAL OF SURVEY; SUBJECT TO PRIOR RIGHTS;		
																		MS 2817;	20.661	PATENT / ME	236879	12/7/1911			
																		MS 3020A, MS 3020B;	25.127	PATENT / ME	538419	7/17/1916			
3																									
9																									
10																									
16																									
17																									
18																									
19																		M&B; SUBDIV UNDEF;		RW TRANSMISSION LINE	PHX-086717	11/1/1916	11 1/2N 1E; CANC 11/23/1966;		
																		MS 3142;	34.833	PATENT / ME	585779	5/23/1917	11N 1W;		
14																									
23																		HES 355;	41.83	PATENT / ME	712271	10/11/1919			
23																		HES 471;	13.21	PATENT / HE	721693	11/28/1919			
23																		MS 3648;	41.322	PATENT / ME	870664	6/30/1922			
24																		MS 3910;	20.113	PATENT / ME	950090	12/16/1924			
																		ALL SECS 2, 16, 32, 36;		STATE GRANT	ACT OF CONGRESS	1/25/1927	EXTENDS ACT OF 6/20/1910 TO MINERAL LANDS; SUBJECT TO PRIOR RIGHTS;		
22																									
23																									
26																									
27																		MS 3893;	183.603	PATENT / ME	1037666	5/24/1930			

TOWNSHIP 11 NORTH RANGE 01 EAST OF THE GILA & SALT RIVER MERIDIAN, ARIZONA

SECS	SUBDIVISION																Acres	Kind of Entry or Purpose	Serial Number or Order Number	Action Date	Remarks		
	NE 1/4				NW 1/4				SW 1/4				SE 1/4									Lots	Other Description
	NE	NW	SW	SE	NE	NW	SW	SE	NE	NW	SW	SE	NE	NW	SW	SE							
For orders affecting disposal or use of unidentified lands withdrawn for classification, minerals, water, and/or other public purposes, and Indian treaties, refer to Index to Miscellaneous Documents																							
7																		M&B; ALL LANDS LYING WITHIN 25 FT OF CENTER LINE OF TRANSMISSION LINE;	O WDL PWR PROJECT	AR-1120	9/20/1930	OTHER TPS: 10N 1W, 11N 1W; REVOKED, OPEN TO ENTRY AND CASE CLOSED 2/22/1996;	
22																							
26																							
27																							
35																							
36																		M&B; ALL LANDS LYING WITHIN 25 FT OF CENTER LINE OF TRANSMISSION LINE;	O WDL PWR PROJECT	AR-1167	6/16/1931	ENLGMT O 7/3/1935; 10N 1E; REVOKED, OPEN TO ENTRY AND CASE CLOSED 2/22/1996;	
36																	640.00	IL BASE	117	10/3/1933	21N 4W;		
2																	640.00						
16																	640.00						
32	X	X	X		X	X			X	X	X	X	X	X	X	X		560.00	IL BASE	118	2/2/1934	21N 4W;	
35													X		X	X		ALL LANDS LYING WITHIN 25 FT OF CENTER LINE OF TRANSMISSION LINE;	O ENLGMT PWR PROJECT, O 6/16/1931	AR-1167	7/3/1935	O MOD 8/14/1936; 10N 1E;	
35													X		X	X		ALL LANDS LYING WITHIN 25 FT OF CENTER LINE OF TRANSMISSION LINE;	O MOD PWR PROJECT, O 7/3/1935	AR-1167	8/14/1936	1N 10E; REVOKED, OPEN TO ENTRY AND CASE CLOSED 2/22/1996;	
1																		PART E2;	R/W TRANSMISSION LINE	PHX-085401	3/2/1950	PERPETUAL; OTHER TPS: 3N 5E, 5N 4E, 6N 3E, 7N 2E, 7N 3E, 8N 2E, 9N 2E, 9 1/2N 2E, 10N 2E, 11N 2E, 12N 1E, 13N 1E, 13N 1W, 14N 1W;	
20																							
21																							
22																							
23																							
24																							
25																							
26																							
29																							
30																							
31																		M&B; SUBDIV UNDEF;	R/W TRANSMISSION LINE	PHX-086930	5/8/1953	10N 1W; EXPIRED AND CASE CLOSED 5/7/2003;	

TOWNSHIP 11 NORTH RANGE 01 EAST OF THE GILA & SALT RIVER MERIDIAN, ARIZONA

SECS	SUBDIVISION																Acres	Kind of Entry or Purpose	Serial Number or Order Number	Action Date	Remarks		
	NE 1/4				NW 1/4				SW 1/4				SE 1/4									Lots	Other Description
	NE	NW	SW	SE	NE	NW	SW	SE	NE	NW	SW	SE	NE	NW	SW	SE							
For orders affecting disposal or use of unidentified lands withdrawn for classification, minerals, water, and/or other public purposes, and Indian treaties, refer to Index to Miscellaneous Documents																							
25																		M&B; SUBDIV UNDEF;		R/W TRANSMISSION LINE	PHX-086931	5/8/1953	OTHER TPS: 10N 2E, 11N 2E, 11 1/2N 1E, 12N 1E; EXPIRED AND CASE CLOSED 5/7/2003;
4																							
5																							
6																				DETERMINATION AREA PL 167	AR-017608	4/25/1957	DET COMP 1/7/1964; OTHER TPS: 12N 1E, 12N 1W, 12 1/2N 1W, 12N 2W, 12 1/2N 2W, 13N 1W, 13N 2W, 13N 3W, 14N 2W, 14N 3W;
1																		ALL;					
2																		ALL;					
3																		ALL;					
7																		ALL;					
8																		ALL;					
9																		ALL;					
10																		ALL;					
11																		ALL;					
12																		ALL;					
13																		ALL;					
14																		ALL;					
15																		ALL;					
16																		ALL;					
17																		ALL;					
18																		ALL;					
19																		ALL;					
20																		ALL;					
21																		ALL;					
22																		ALL;					
23																		ALL;					
24																		ALL;					
25																		ALL;					
26																		ALL;					
27																		ALL;					



TOWNSHIP 11 NORTH RANGE 01 EAST OF THE GILA & SALT RIVER MERIDIAN, ARIZONA

SECS	SUBDIVISION																Acres	Kind of Entry or Purpose	Serial Number or Order Number	Action Date	Remarks		
	NE 1/4				NW 1/4				SW 1/4				SE 1/4									Lots	Other Description
	NE	NW	SW	SE	NE	NW	SW	SE	NE	NW	SW	SE	NE	NW	SW	SE							
For orders affecting disposal or use of unidentified lands withdrawn for classification, minerals, water, and/or other public purposes, and Indian treaties, refer to Index to Miscellaneous Documents																							
28																	ALL;						
29																	ALL;						
30																	ALL;						
31																	ALL;						
32																	ALL;						
33																	ALL;						
34																	ALL;						
35																	ALL;						
36																	ALL; 9N 1E;	DETERMINATION AREA PL 167	AR-021164	7/9/1959	DET COMP 7/20/1967;		
25																	M&B;						
36																	M&B;	MINING CLAIM LOCATION - PL 359	A-9270	10/17/1975			
32			X			X											80.00	IL BASE	575	7/19/1983			
28																	M&B;						
29																	M&B;						
30																	M&B;						
31																	M&B;						
32																	ALL;						
33																	M&B;						
34																	M&B;						
35																	M&B;	DES CASTLE CREEK WILDERNESS AREA PL 98-406	A-6216	8/28/1984	WDN FROM MINING AND MINERAL LEASING;		
28			X	X			X	X									PART N2N2;						
29			X					X			X	X	X	X	X		NESWNE, S2SWNE, S2SENE, E2W2SW; PART N2NE, NWSWNE, N2SENE, SWNW, W2W2SW;						
30																	PART E2SESE;						
31											X				X		PART NE, SESESW, W2SE;						
32																	ALL;						
33	X	X	X	X	X	X	X	X	X	X	X	X	X	X	X		PART SESW, NWSE;						
34																	PART S2NESE, S2S2;						

TOWNSHIP 11 NORTH RANGE 01 EAST OF THE GILA & SALT RIVER MERIDIAN, ARIZONA

SECS	SUBDIVISION																Acres	Kind of Entry or Purpose	Serial Number or Order Number	Action Date	Remarks		
	NE 1/4				NW 1/4				SW 1/4				SE 1/4									Lots	Other Description
	NE	NW	SW	SE	NE	NW	SW	SE	NE	NW	SW	SE	NE	NW	SW	SE							
For orders affecting disposal or use of unidentified lands withdrawn for classification, minerals, water, and/or other public purposes, and Indian treaties, refer to Index to Miscellaneous Documents																							
35																		PART W2SW;		WDL CASTLE CREEK WILDERNESS AREA, PL 98-406	A-28558	8/28/1984	SEGREGATED FROM THE PUBLIC LAND LAWS AND THE MINING LAWS, INCLUDING THE MINERAL LEASING LAWS; PERPETUAL; LD TP: 9N 10E;
22																		MS 3893;					
27																		MS 3893;		WD TO US	AZA-24166	7/30/1992	LD TP: 13N 6E;
14																		HES 355;					
23																		HES 355;		WD RECON	AZA-33870	6/19/2007	OTHER TP: 19N 2W;

DEPARTMENT OF INTERIOR  
BUREAU OF LAND MANAGEMENT

Input Parameters for Geographic Report with Land

System Id = CR

Admin State = AZ

Geo State =

Casetype Begins With

Case Disp Txt = AUTHORIZED, CANCELLED, EXPIRED, PENDING, REJECTED, RELINQUISHED, VOID, WITHDRAWN

Mer Twp Rng =

Section =

Mtrs = 14 0110N 0010E 036, 14 0110N 0010E 999

Commodity =

Commodity Txt =

Pending Org =

Pend Org Decode =

Total Rows Returned: 0

# UNSURVEYED TOWNSHIP 11 NORTH RANGE 1 EAST OF THE GILA AND SALT RIVER MERIDIAN, ARIZONA

PROTRACTION DIAGRAM NO 16 OFFICIALLY FILED 12/07/1959

YAVAPAI COUNTY  
HASSAYAMPA FIELD OFFICE

STATUS OF PUBLIC DOMAIN  
LAND AND MINERAL TITLES

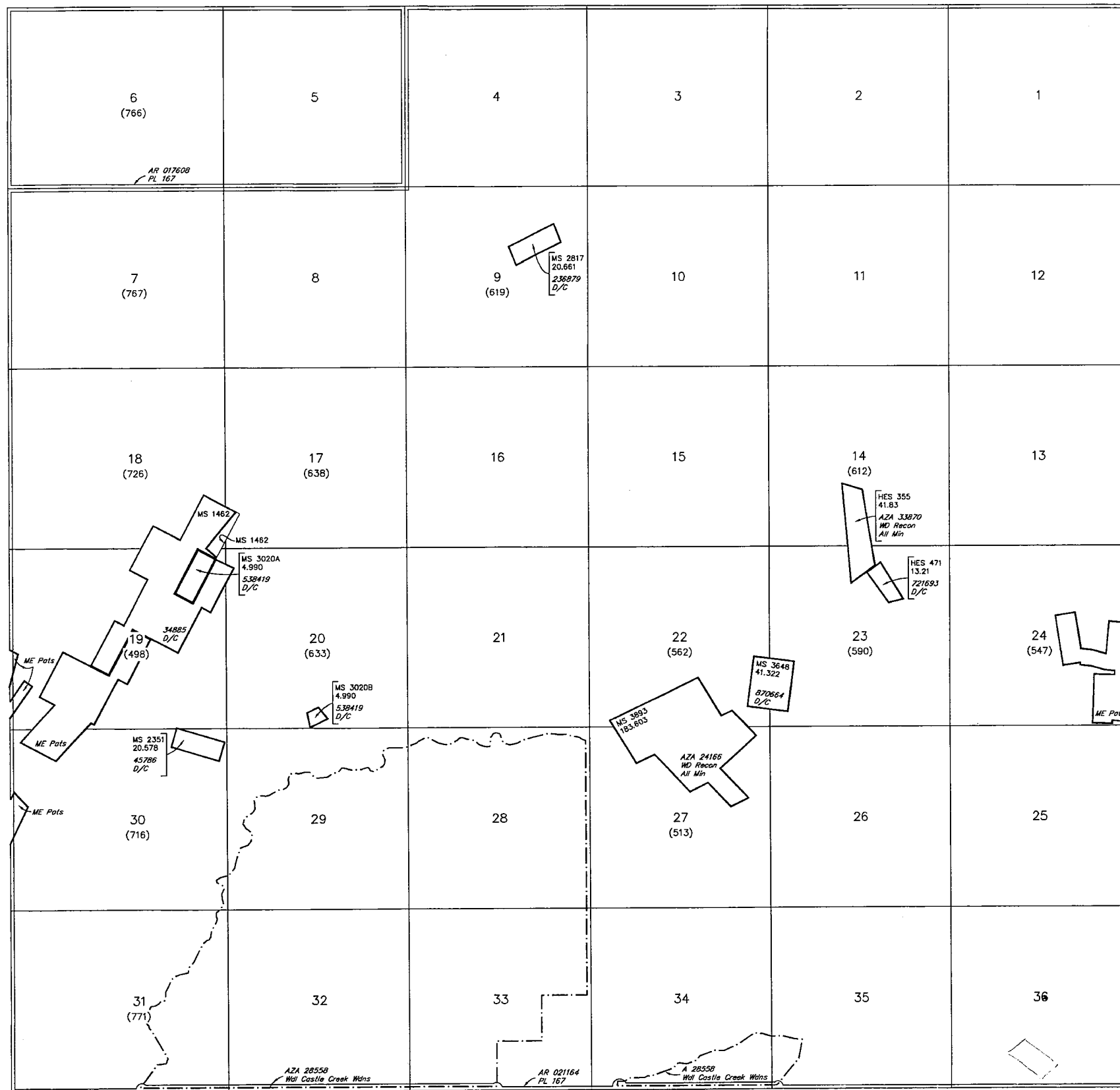

INDEX TO SEGREGATED TRACTS				
RESURVEY TRACT NO	ORIGINAL SURVEY			
	T	R	SEC	SUBDIVISION

FOR ORDERS AFFECTING DISPOSAL OR USE OF UNIDENTIFIED LANDS WITHDRAWN FOR CLASSIFICATION, MINERALS, WATER AND/OR OTHER PUBLIC PURPOSES, REFER TO INDEX OF MISCELLANEOUS DOCUMENTS.

MDS 9 NW  
10 SW  
11 SE

All Tp included in Wdl Prescott NF Proc 10/21/1899

PHX 085401 R/W Transmission Line 100'  
Sec 1- E1/2

T 11N  
R 2E  
T 10N

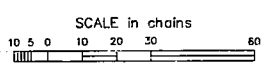

WARNING STATEMENT  
This plot is the Bureau's record of Title, and should be used only as a graphic display of the township survey data. Records herein do not reflect the changes which may have been effected by later movements of the, or other bodies of water. Refer to the cadastral surveys for official survey information.

CURRENT TO	NW	GSR Mer
2-25-2013	ACAD	T 11 N
		R 1 E